

RAYCAST® HIGH PRECISION BASE PLATE-TO-COUCH TOP FIXATION DEVICES

2-PIN BAR FOR PIN-POINT COUCH WITH A WIDTH OF 53 CM (MRI COMPATIBLE)

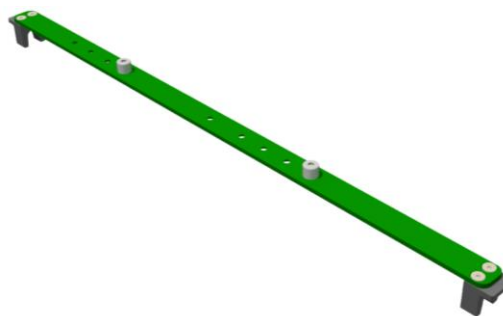

Article No. : **33219**

A. GENERAL PRODUCT INFORMATION

This product is a fixation device to attach Raycast High Precision base plates to pin-point couch tops with a width of 53 cm.

B. PRODUCT DESCRIPTION

This 2-pin bar has two positioning blocks that fit over the indexing pins on the sides of pin-point style couches with a width of 53cm exactly. It can be used to index hardware (base plates, shoulder positioning device, leg indexing system, etc.) directly or via an adapter plate to the couch. More information on the compatible products can be found in the respective 'instructions for use' and on www.orfit.com.

C. POSITIONING ON A COUCH

The bar is designed for couches with a width of 53cm.

The two blocks of this fixation device have a slot which fits over the pins of the pin-point style indexing system.

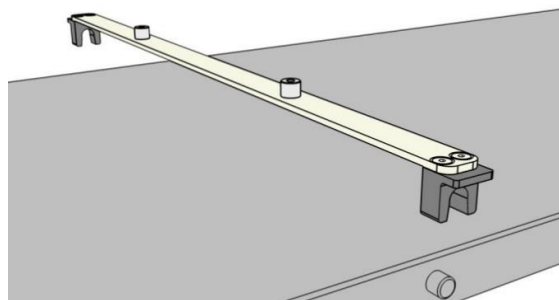

Push the bar over a set of pins until it clicks in place. The bar itself should now be flat on the surface of the couch. Always make sure that the bar is well positioned on the couch before indexing the other hardware.

To remove the bar, hold the two ends of the bar and pull until the bar snaps off the couch. Never pull in the middle of the bar.

D. STORAGE

Always store the product in a safe place to prevent it from getting damaged.
Store the product between +10°C (50°F) and 40°C (122°F).

E. PROPERTIES

E.1 Physical Properties

Dimensions: L 576 x W 25 x H 38,5 mm
L 22.68" x W 0.98" x H 1.52"

Weight: +/- 0.11 kg / 0.24 lbs

E.2 Material Properties

Material POM (pins/blocks): 1,4 gr/cm³
Material PC (screws): 1,2 gr/cm³
Material Glass Fibre (bar): 1,8 gr/cm³

This product is made entirely of durable plastics and is MR-safe.



Warning: keep metal wrenches which might be supplied in the package out of the MRI room.

E.3 Dosimetric Properties

Attenuation factor (± 0.15 %)	
6 MV	2.67%
15 MV	2.00%
H ₂ O equivalence	7.72 mm

Note: Use these numbers as a guidance only. Perform the measurements again in your department to verify these results.

F. MAINTENANCE AND WASTE MANAGEMENT

This product can be cleaned and disinfected by means of soapy water or an isopropanol based disinfectant, applied with a soft cloth. If unsure about the cleaning fluid, do not use. **Never use aerosol sprays, corrosive cleaning agents, solvents or abrasive detergents.**

Periodic checks of the product should be done to insure the parts are not worn and require repair or replacement. **Do not**

attempt to make repairs yourself. Contact your distributor if there are any questions or concerns.
The product can be disposed of with household waste.

G. ADDITIONAL INFORMATION

For additional information such as distributor contact information, product brochures, Material Safety Data Sheets and regulatory information, please visit our website www.orfit.com.

Note:

It is prohibited to make alterations to this text without prior approval from Orfit Industries.
RAYCAST® is a registered trademark of ORFIT INDUSTRIES.



ORFIT INDUSTRIES
Vosveld 9A | B-2110 Wijnegem | Belgium
T (+32) (0)3 326 20 26
welcome@orfit.com

www.orfit.com



Ref. No. 50225
VERSION 1
LAST UPDATE: 15/04/2021
REVISION DATE: 15/04/2023